

HENRY TOOLS

Industrial Airtools at Work

Models

4705-RA

4705-RAZ

SERIES

General Safety and Maintenance Manual



GOVERNED SPEED RIGHT ANGLE SANDER

Model Number	Exhaust Direction	Throttle Type	Speed	Power Output	Case Material	Weight		Length	Diameter	Air Consumption	Spindle Thread
						Aluminum					
4705-RA	Side	(L) Lever or (K) Safety Lever	7000 to 10000 R.P.M (8000rpm is standard)	0.9 H.P. (675 W)	Aluminum	2.75lbs.		11.18 Inch 284mm	1 3/4" 4.4cm	25 CFM (11.8 L/S)	3/8-24 x 0.98 Inch
4705-RAZ						1.2kg					5/8-11 x 0.98 Inch

The Henry Tool Co., Manufactured by Henry Tools
 498 So. Belvoir Blvd., South Euclid, OH 44121 U.S.A.
 Ph: (216) 291-1011 or (800) 826-5257 • Fax: (216) 291-5949 or (800) 303-2800
 Email: daviidh@msn.com • Website: www.Henrytools.com

**Models
4705-RA
4705-RAZ
SERIES**

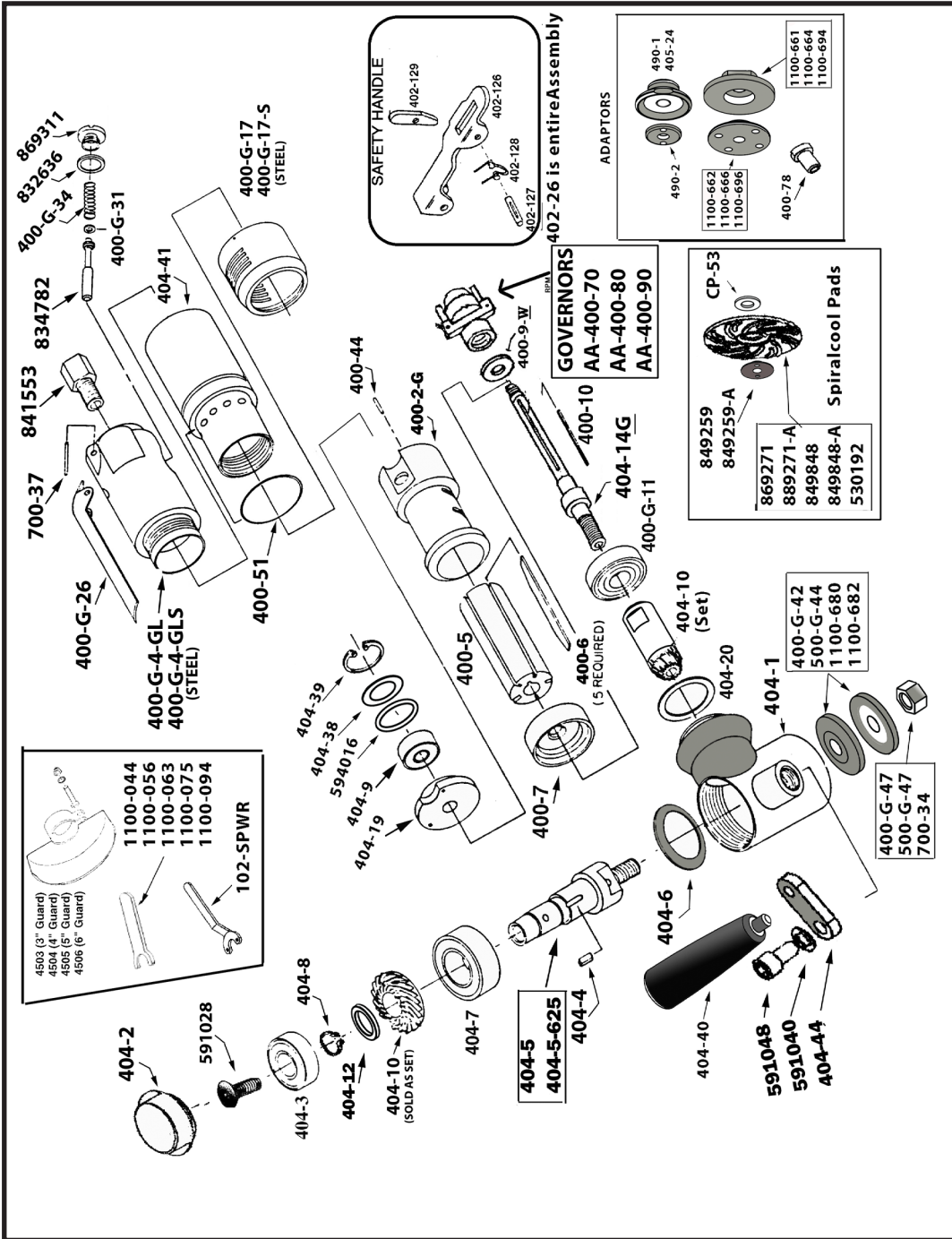

HENRY TOOLS, INC. Ph: (216) 291-1011 or (800) 826-5257



**Models
4705-RA
4705-RAZ
SERIES**

PART NUMBER	DESCRIPTION
400-G-11	FRONT BEARING
400-G-26	LEVER
400-G-4-GL	ALUMINUM BACKHEAD
400-G-4-GLS	STEEL BACKHEAD
400-G-34	SPRING
400-G-42	3/8 I.D. FLANGE FOR USE WITH (2"-3" WHEELS)
400-G-47	3/8-24 NUT
400-9-W	GOVERNOR WASHER
400-10	KEY
400-44	PIN
400-2G	CYLINDER
400-5	ROTOR
400-6	BLADE (5 ARE REQ.)
400-7	FRONT THRUST PLATE
400-G-17	ALUMINUM SIDE EXHAUST
400-G-17-S	STEEL SIDE EXHAUST
400-51	O-RING
402-126	SAFETY LEVER
402-127	SAFETY LEVER PIN
402-128	LOCKOUT LEVER
402-129	SAFETY LEVER SPRING
402-132	ALUMINUM CASE (SPECIFY SPEED)
402-134	SCREEN MUFFLER
404-1	ANGLE HEAD HOUSING
404-2	BEARING CAP
404-3	BEARING
404-4	KEY
404-5	3/8-24 X .980 OUTPUT SPINDLE
404-5-625	5/8-11 X .980 OUTPUT SPINDLE
404-6	WAVY WASHER (2 Are Req'd)
404-7	LOWER OUTPUT SPINDLE BEARING
404-8	SNAP RING
404-9	REAR MOTOR BEARING
404-10	GEAR SET
404-12	SPACER RING
404-14G	GOVERNED SPINDLE

PART NUMBER	DESCRIPTION
404-19	REAR ENDPLATE
404-20	MOTOR SPACER
404-38	BEARING COVER
404-39	SNAP RING
404-40	DEAD HANDLE
404-41	ALUMINUM MOTOR CASE
404-44	DEAD HANDLE OFFSET
410-G-17-S	SIDE EXHAUST SLEEVE
500-G-44	3/8 I.D. FLANGE (4"-5" WHEELS)
500-G-47	1/2-13 NUT
501-G-47	1/2-20 NUT
700-34	5/8-11 NUT
700-37B	Throttle Lever Pin
1100-680	5/8 I.D. FLANGE (6" OR SMALLER WHEELS)
1100-682	3/8 I.D. FLANGE (5"-6" WHEELS)
591028	SCREW
591040	WASHER
591048	SCREW
592016	SNAP RING
594016	O-RING
832636	GASKET
834782	VALVE (Includes 844302 "O"RING)
841552	3/8 NPT TO 3/8 NPT BUSHING
841553	3/8 NPT TO 1/4 NPT BUSHING (STANDARD)
844302	O-RING
869311	THROTTLE VALVE CAP
GUARDS	DESCRIPTION
4503	3" GUARD
4504	4" GUARD
4505	5" GUARD
4506	6" GUARD
WRENCHES	
490-3	SPANNER WRENCH (PIN TYPE)
102-SPWR	WRENCH FOR SANDING PADS
1100-044	7/16" WRENCH
1100-056	9/16" WRENCH

HENRY TOOLS, INC. Ph: (216) 291-1011 or (800) 826-5257

Models
4705-RA
4705-RAZ
SERIES



PART NUMBER	DESCRIPTION
1100-075	3/4" WRENCH
ASSEMBLIES	
PART	DESCRIPTION
AA-400-70	GOVERNOR 7000RPM
AA-400-80	GOVERNOR 8000RPM
AA-400-90	GOVERNOR 9000RPM
510120	REPAIR KIT (ALL BEARINGS AND BLADES and SNAP RINGS)
402-26	SAFETY LEVER ASSY.
ACCESSORIES	
PART	DESCRIPTION
CP-53	WASHER
300-16	1/8" COLLET ADAPTER
300-16-3/32	1/4" TO 3/32" COLLET ADAPTER
400-78	3/8-24 TO 5/8-11 ADAPTER
400-78-S	3/8-24 x 1/4 SET SCREW
405-24	BACKING PLATE FOR 490-KR
490-K	3/8-24 X .980 TYPE 27 ADAPTER ASSY.
490-KR	3/8-24 X .580 TYPE 27 ADAPTER ASSY.
490-1	BACKING PLATE FOR 490-K
490-2	NUT FOR 490-K & 490-KR
1100-660	3/8-24 TO 5/8 I.D. TYPE 27 ADAPTER ASSY.
1100-661	3/8-24 TO 5/8 I.D. BACKING PLATE
1100-662	3/8-24 TO 5/8 I.D. ADAPTER NUT
1100-664	3/8-24 TO 7/8 I.D. BACKING PLATE
1100-666	3/8-24 TO 7/8 I.D. ADAPTER NUT
1100-668	3/8-24 TO 7/8 I.D. TYPE 27 ADAPTER ASSY.
1100-692	5/8-11 TO 7/8 I.D. TYPE 27 ADAPTER ASSY.
1100-694	5/8-11 TO 7/8 I.D. BACKING PLATE
1100-696	5/8-11 TO 7/8 I.D. ADAPTER NUT
849259	5/8-11 SANDING PAD NUT
849259-A	3/8-24 SANDING PAD NUT
889271	5/8-11 4" SANDING PAD (MAX 12000 RPM)

PART NUMBER	DESCRIPTION
889271-A	3/8-24 4" SANDING PAD (MAX 12000 RPM)
849848	5/8-11 5" SANDING PAD (MAX 10000 RPM)
849848-A	3/8-24 5" SANDING PAD (MAX 10000 RPM)